

STRUCTURED FEMALE SIZING VEST INSTRUCTIONS

Please Print

Officer's Full Name: _____ Badge No.: _____
 Department: _____ Telephone No.: () _____
 Measured By: _____ Date Of Measuring _____
 Distributor's Name: _____ PO# _____
 Model: _____ Level: _____ Color: _____ Type of Carrier _____
HEIGHT: _____ ft. _____ ins. **WEIGHT:** _____ lbs. **Bra Cup Size** _____

STEP 1 RECORD CUP SIZE

Record officer's cup size in the size ticker at the bottom of the page.

THE FOLLOWING MEASUREMENTS SHOULD BE TAKEN *STANDING*

STEP 2 FULL CHEST MEASUREMENT

Position a soft measuring tape around the officer's full chest area and measure around the back, directly under arm pits, meeting across center chest front. When necessary, round up.

EXAMPLE: 35" ins.

STEP 3 TOTAL GIRTH MEASUREMENT

Measure waist at **widest** circumference in between the chest and the top of the duty belt. Then add Full Chest and Girth together and divide by 2 to achieve the Total Girth. When necessary, round up.

EXAMPLE: 28" ins.

FULL CHEST	35"	/ 2 =	32"
+			
GIRTH	28"		TOTAL GIRTH

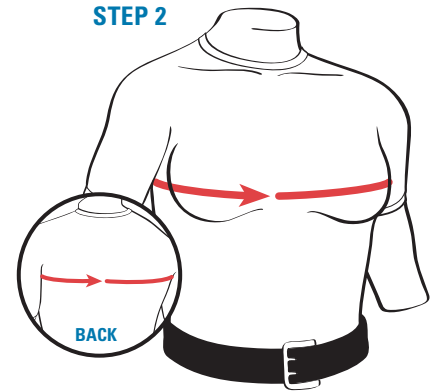

STEP 4 OVERLAP CALCULATION

Take the Total Girth obtained from STEP 3 and add your Overlap preference (reference the overlap calculations below).

EXAMPLE: 32" + 3" = 35"

TOTAL GIRTH
OVERLAP
=
TOTAL GIRTH + OVERLAP

- Overlap Calculation**
- Butt Fit – add 1"
 - 1" Overlap – add 3"
 - 2" Overlap – add 5"

STEP 3

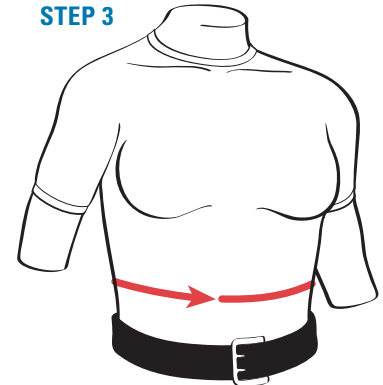

STEP 5 VEST PANEL WIDTH SIZE CALCULATION

To achieve your Vest Panel Width Size, take the Total Girth + Overlap obtained from STEP 4 and divide by 2. If the Vest Panel Width Size that you calculate is in between two whole numbers, round up to the nearest whole number.

EXAMPLE: 35" / 2 = 18"

VEST PANEL WIDTH

Using this Vest Panel Width size, choose your front and back panel sizes from the charts below. Note, if your Vest Panel Width Size is not featured below, choose the next size up. The front and back panel sizes should be equal to the Total Girth + Overlap.

FRONT PANEL WIDTH CHOICES					
16	18	20	22	24	26

BACK PANEL WIDTH CHOICES									
16	18	20	22	24	26	28	30	32	34

SIZE:

STEP 1	STEP 5	STEP 8	STEP 9	STEP 10	STEP 5	STEP 11
CUP SIZE	FRONT PANEL WIDTH	FRONT-TOP TORSO	FRONT BOTTOM TORSO	CHEST WIDTH	BACK PANEL WIDTH	BACK PANEL LENGTH

STEP 6



INITIAL POSITIONING

After selecting front and back panel sizes, have the officer position the front panel alone on her desired mid apex point. For a better fit, allow the officer to check the position of the front panel in a mirror and explain the highlighted apex mid-line. With the officer holding the front panel in place, attach the back panel.

STEP 7



CONFIRM OVERLAP

Verify appropriate overlap on each side of the vest has been achieved. If more overlap is needed, grow from the back panel.

STEP 8



TOP TORSO - CRITICAL MEASUREMENT

Using the fixed tape measure, identify the number that corresponds with the bottom of the side shoulder clavicle bone. When in doubt, lean towards a shorter measurement. If this measurement is too long, it will drop the bust line too low.

STEP 1	STEP 5	STEP 8	STEP 9	STEP 10	-	STEP 5	STEP 11
CUP SIZE	FRONT PANEL WIDTH	FRONT-TOP TORSO	FRONT BOTTOM TORSO	CHEST WIDTH		BACK PANEL WIDTH	BACK PANEL LENGTH

STEP 9

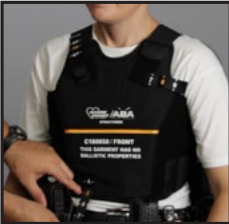

BOTTOM TORSO

Using the fixed tape measure in a seated position, identify the number that corresponds with the top of the duty belt. Give a 1/2 inch space in between each.

STEP 1	STEP 5	STEP 8	STEP 9	STEP 10	-	STEP 5	STEP 11
CUP SIZE	FRONT PANEL WIDTH	FRONT-TOP TORSO	FRONT BOTTOM TORSO	CHEST WIDTH		BACK PANEL WIDTH	BACK PANEL LENGTH

STEP 10



CHEST WIDTH

Using the fixed tape measure, identify the number that corresponds with the proper width of the chest. Confirm when officer is in driving/shooting position that the width does not cut into under arm area.

STEP 1	STEP 5	STEP 8	STEP 9	STEP 10	-	STEP 5	STEP 11
CUP SIZE	FRONT PANEL WIDTH	FRONT-TOP TORSO	FRONT BOTTOM TORSO	CHEST WIDTH		BACK PANEL WIDTH	BACK PANEL LENGTH

STEP 11



BACK LENGTH

Using the fixed tape measure, identify the number that corresponds with the top of the duty belt. Give a 1/2 inch space in between each.

STEP 1	STEP 5	STEP 8	STEP 9	STEP 10	-	STEP 5	STEP 11
CUP SIZE	FRONT PANEL WIDTH	FRONT-TOP TORSO	FRONT BOTTOM TORSO	CHEST WIDTH		BACK PANEL WIDTH	BACK PANEL LENGTH

SIZE:

STEP 1	STEP 5	STEP 8	STEP 9	STEP 10	-	STEP 5	STEP 11
CUP SIZE	FRONT PANEL WIDTH	FRONT-TOP TORSO	FRONT BOTTOM TORSO	CHEST WIDTH		BACK PANEL WIDTH	BACK PANEL LENGTH

COMMENTS: